



Series Catalog

## BESTWARE Hardware Production Co., Ltd.

Add: Block 8, No.6, Jianda Nan Road, Jiangmen, Guangdong, China

Email: [business@bestware-stainless.com](mailto:business@bestware-stainless.com)    [after-sales@bestware-stainless.com](mailto:after-sales@bestware-stainless.com)

WhatsApp: +86 18929047065    Tel: +86 750 3108801

Wechat: +86 18929047065



Website



YouTube



WhatsApp



Wechat

Expertise in Stainless Steel

# SPRAY VALVE

PREMIER SOLUTION PROVIDER OF ONE-STOP STAINLESS COMMERCIAL FAUCETS

# CONTENTS

## SPRAY VALVE

---

Dual Function 01

Single Function 02

### ✓ Product Advantages

Since its establishment, Bestware has always adhered to the principle of "solving industry pain points through product selling points", creating more value for customers. Below is an overview of our unique selling points.



Pre Rinse Faucet

Pain Points	Selling Points
Brass spray valve, single function, low power, easy fatigue	Patented stainless steel spray valve, dual-function with one-click switching (powerful and large-area washing), 24 precision nozzles for high-pressure, wide spray coverage, featuring hydraulic cushioning and ergonomic structure, reduce 75% of muscle strain and minimize water hammer

**Note:** Suitable for European, American and Affordable Luxury Streamlined Style Models

### ✓ Our Commitments

**97%+** Product Satisfaction Upon Receipt by Customers

**100%** 304/316 Stainless Steel (Unless Specified Otherwise)

**100%** Product Qualification Rate at Factory Shipment

**100%** Customer Complaint Resolution Rate



**Take Bestware for a spin, and it'll be your go-to forever!**

# SPRAY VALVE

EXPERTISE IN STAINLESS STEEL  
**BESTWARE**  
 ONE-STOP SOLUTION PROVIDER OF STAINLESS COMMERCIAL FAUCETS



Flow Rate Table

**100% SUS304**  
WETTED PARTS



## BWSG-SSE

Patented Dual-function Spray Valve

Key Parts	Features	
Spray Valve	Dual-function	Two Modes for Powerful Washing and Large-area Washing
		24 Precisely Designed Angles Ensure Uniform Flow and Broad Coverage
		Reduces Water Hammer, Protecting Water Piping
	Ergonomic Hydraulic Buffer Reduces Fatigue during Extended Use	
Material	SUS304, up to 200,000+ Cycles	

EXPERTISE IN STAINLESS STEEL  
**BESTWARE**  
 ONE-STOP SOLUTION PROVIDER OF STAINLESS COMMERCIAL FAUCETS

# SPRAY VALVE

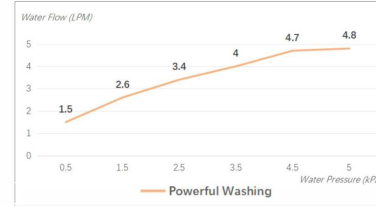

Flow Rate Table

**100% SUS304**  
WETTED PARTS

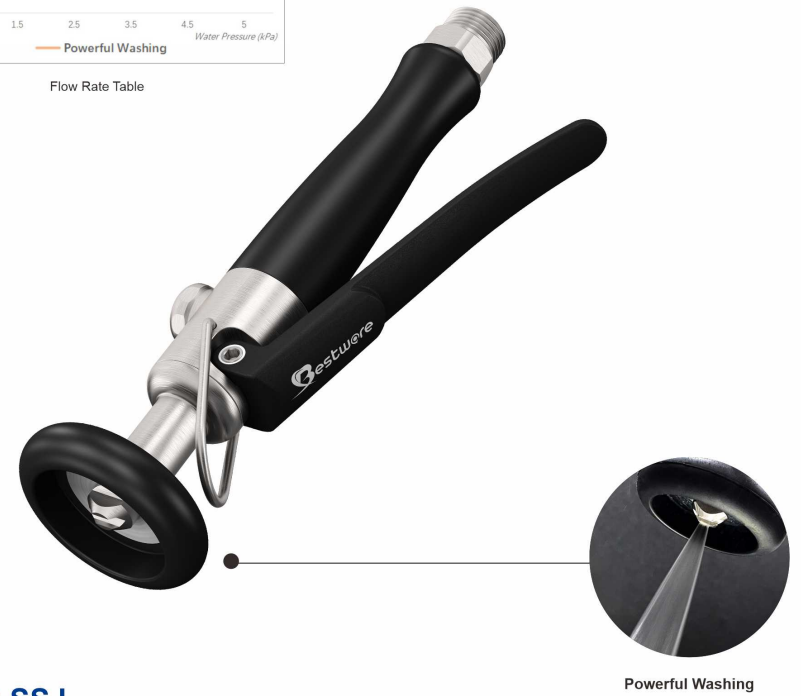

## BWSG-SSJ

Single-function Spray Valve

Key Parts	Features	
Spray Valve	Single-function	Single Mode for Powerful Washing
		Reduces Water Hammer, Protecting Water Piping
	Ergonomic Hydraulic Buffer Reduces Fatigue during Extended Use	
Material	SUS304, up to 200,000+ Cycles	