



BESTWARE Hardware Production Co., Ltd.

Add: Block 8, No.6, Jianda Nan Road, Jiangmen, Guangdong, China

Website: www.bestware-sparkling.com

Email: business@bestware-stainless.com after-sales@bestware-stainless.com

WhatsApp: +86 18929047065 Tel: +86 750 3108801

Wechat: +86 18929047065



Website



YouTube



WhatsApp



Wechat

2025 V2.0



Commercial Water Dispenser (2 in 1) INSTRUCTION MANUAL



Applicable Models: G5DS-15, G5DS-105

ONE-STOP SOLUTION PROVIDER OF COMMERCIAL WATER DISPENSER

CATALOG

01 Instruction Manual

Dispenser Tap Operation Instructions	01
Setting Dispensing Time on Tap	02
Heating Unit Operation Instructions	03
Heating Unit Energy-saving Mode Setting	04
Usage Precautions	05
Error Codes and Troubleshooting	06

07 Installation Manual

Equipment Assembly Components Overview	07
Required Space and Placement Requirements	08
Water and Electrical Positioning Requirements	09
Countertop Cut-out Size	10
Dispenser Tap Installation Steps	10
Tubing Connection Precautions	12
Communication Cable Connection Precautions	13
Power-on Precautions	13
UV Sterilization Module Precautions	14
RO Filtration Unit Wastewater Drain Tube Precautions	15
Safety Valve Drain Hose Precautions	15
Connection Diagram	16
Post-installation Precautions	17
Pre-startup Precautions	17

18 Warranty & Disclaimer

Dispenser Tap Operation Instructions

1. Dispensing Ambient Water:

- 1 Rotate knob to ambient water mode.
- 2 Press center of the knob to start dispensing.
- 3 Display dispensing countdown.



2. Dispensing Hot Water:

- 1 Rotate knob to hot water mode.
- 2 Double-press knob center within 0.5 seconds.
- 3 Display dispensing countdown.



Setting Dispensing Time on the Dispenser Tap

- 1. On the selected mode, press and hold the center of the screen for 5 seconds to enter the time setting.
(Each mode has its own independent time setting with power-off memory. The following example uses ambient water mode.)

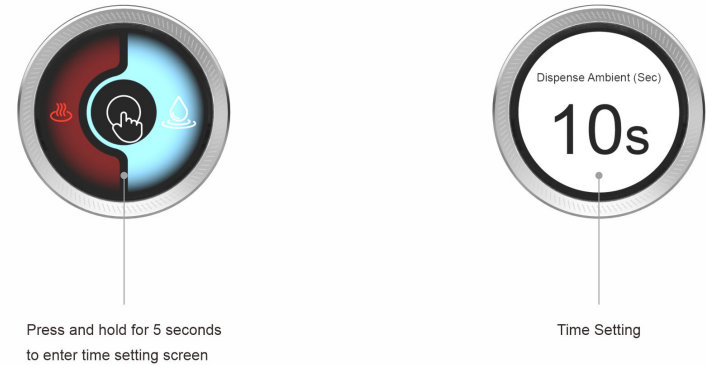

- 2. Rotate knob to set desired time (1-60 seconds).

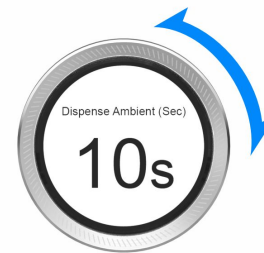

- 3. Press the screen again to confirm.

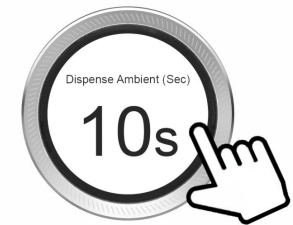

Heating Unit Operation Instructions



1. Press "+" or "-" on the control panel to set the desired temperature (45°C-98°C).

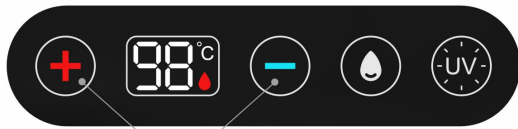

Press to set temperature

2. Indicator Status:

Solid red drop: Heating complete

Flashing red drop: Heating in progress

Solid white drop and UV lights: Normal operation

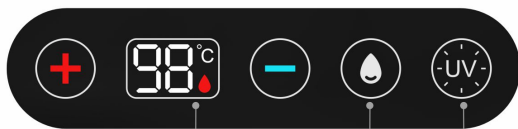

Red drop solid indicates heating complete

Red drop flashes indicates heating in progress

Flashes when refilling water

Below 80°C, the UV light flashes during dispensing;
At 80°C or above, the UV light stays on (indicating effective sterilization)

Heating Unit Energy-saving Mode Setting

1. Press and hold "+" button for 5 seconds to enter the energy-saving mode setting (default is P1).
Press "+" or "-" to switch between energy-saving modes P1, P2, and P3 (one-way switching, no cycling).

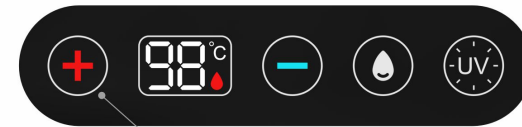

Press and hold for 5 seconds to enter selection interface

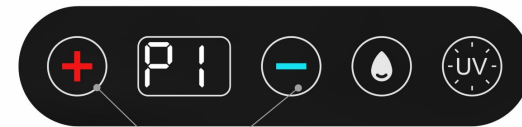

Press "+" or "-" to select mode after entry

Descriptions of Energy-saving Modes

P1-Standard Mode:

Shuts off heating after 24 hours of inactivity. Heating restarts to the set temperature when dispensing resumes.

P2-Insulated Mode:

Drops to 65°C after 3 hours of no dispensing to reduce energy consumption. Shuts off after 24 hours of inactivity. Heating restarts to the set temperature when dispensing resumes.

P3-High Efficiency Mode:

Shuts off heating after 3 hours of inactivity. Heating restarts to the set temperature when dispensing resumes.

2. After selecting, if there is no operation within 5 seconds, it will automatically save the current setting and exit (e.g., P1). The setting is retained even after a power interruption.

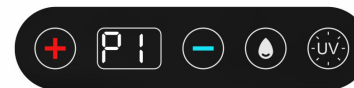

Set the desired mode



Saves mode and returns to the previous screen after 5 seconds

Usage Precautions

1. Heating Unit Precautions:

- 1 Ensure that the electricity meter and wire gauge meet the rated current of the heating unit. Consult a qualified electrician if needed.

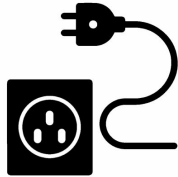

- 2 Keep the power plug dry when connecting to power. Never plug or unplug with wet hands.



- 3 After installation, verify that all wiring and tubing connections are correct before powering on.

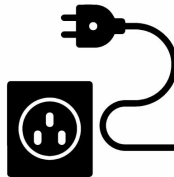

Error Codes and Troubleshooting

Heating Unit



Error Code Display

Error Code	Error Name	Symptoms	Possible Causes	Solution	Image
E0	Water Leakage Protection	All loads shut down, water dispensing disabled (E0 has the highest priority)	Loose internal piping in heating unit causing leakage	Remove side panel to check and re-secure any loose pipes	/
			Water accumulation in leakage protector	Remove right side panel to clean accumulated water in leakage protector	
			Water tank leakage	Contact after-sales service	/
E1	Temperature Sensor Fault	Heating disabled; dispensing and other functions normal	Damaged or faulty temperature sensor	Contact after-sales service	/
E7	Heating Tank Refill Error	Heating tank not refilled within 20 minutes	No water supply to heating tank	Check if water supply is normal	/

Note: Contact after-sales service if above solutions don't resolve the issue

Equipment Assembly Components Overview

1. Dispenser Tap Assembly Components

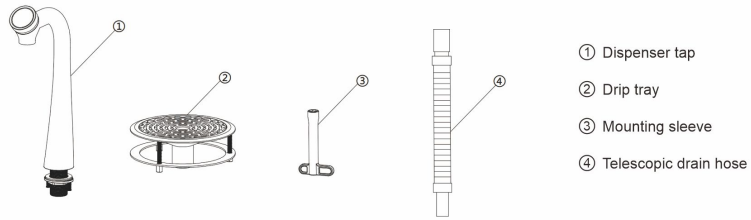

2. Heating Unit Assembly Components

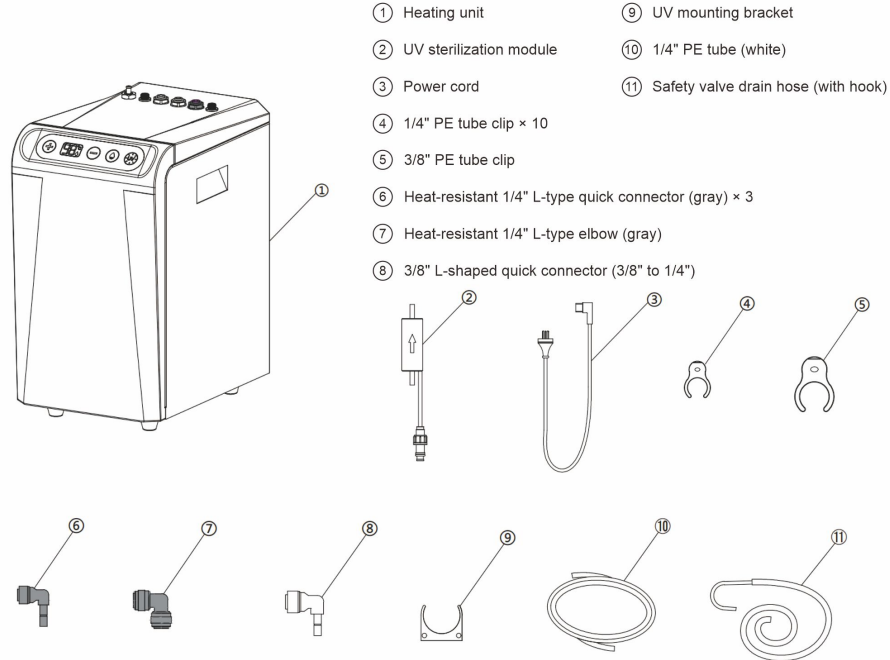

3. RO Filtration Unit Assembly Components

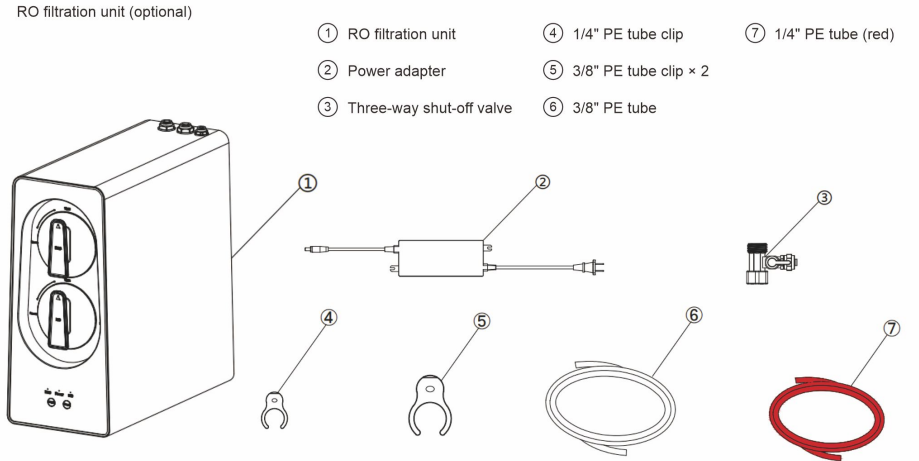

Required Space and Placement Requirements

1. Minimum Clearance for Heating Unit

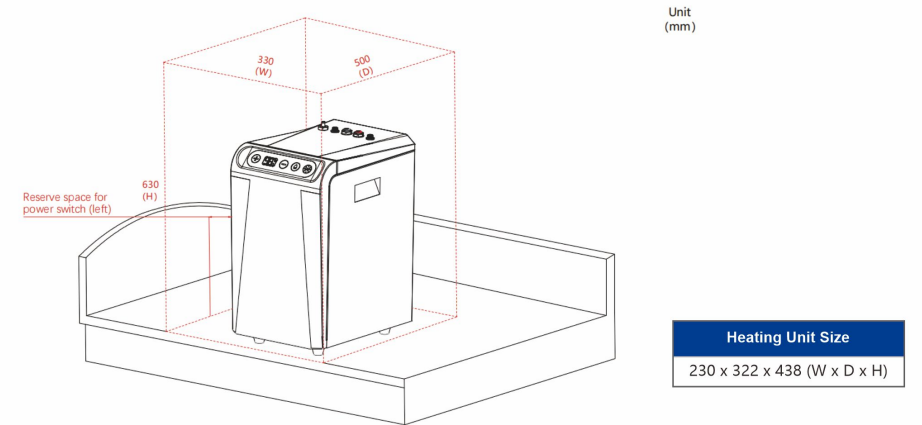

2. Minimum Clearance for RO Filtration Unit (Applicable only to Bestware Unit)

RO filtration unit (optional)

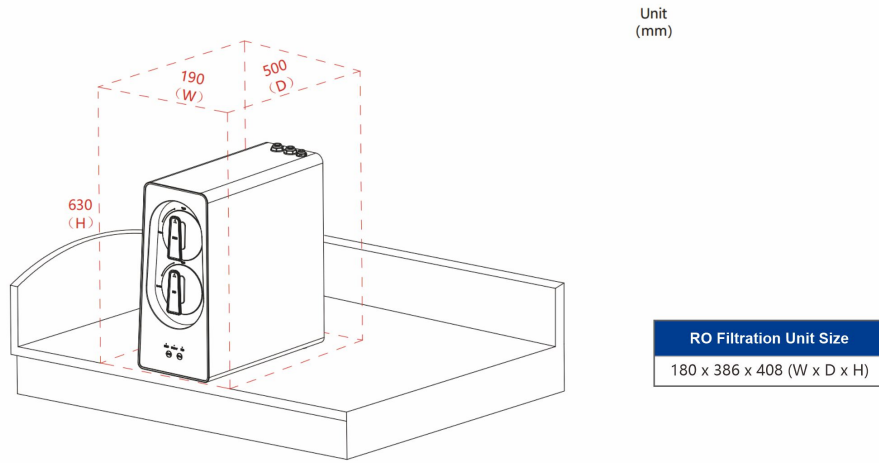

Water and Electrical Positioning Requirements

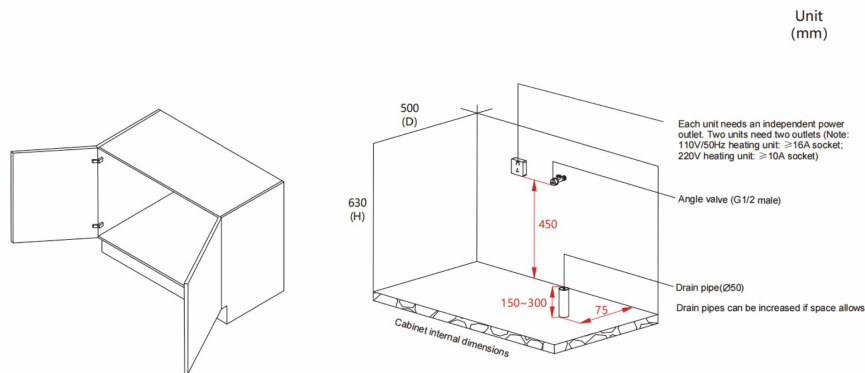

Countertop Cut-out Size

Before installing the dispenser tap, the countertop must be prepared with the required cut-out according to specifications.

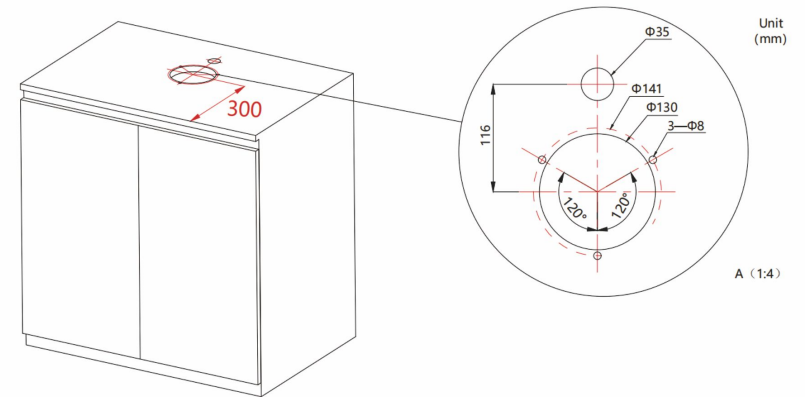

Dispenser Tap Installation Steps

1. Secure Drip Tray: Install the drip tray on the countertop. Secure the nut underneath the countertop first, then tighten it further using the mounting sleeve. (Maximum countertop thickness for drip tray installation: 36mm)

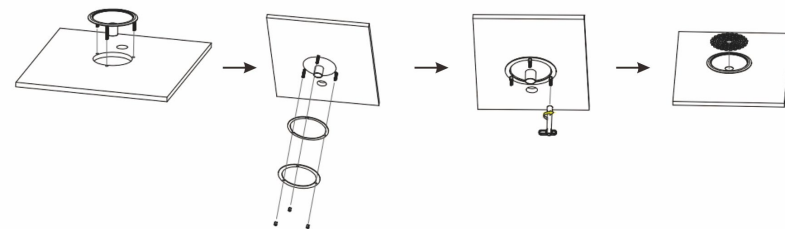

2. Secure Dispenser Tap: Install dispenser tap on countertop. First, fasten mounting nut underneath countertop, then tighten using Phillips screwdriver. (Maximum countertop thickness for dispenser tap installation: 40mm)

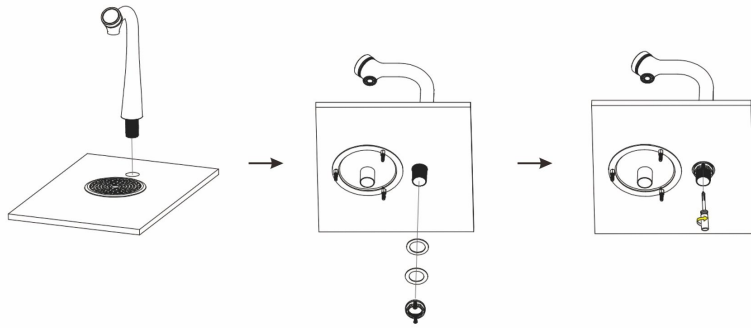

3. Install Telescopic Drain Hose: Connect the drip tray and the drain pipe using the telescopic drain hose.

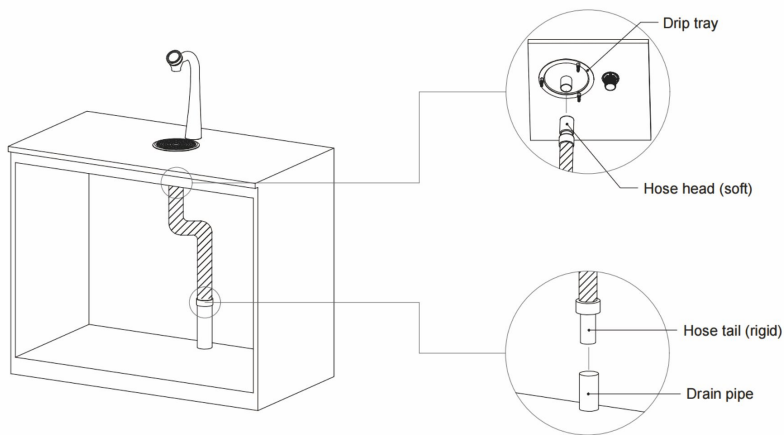

Tubing Connection Precautions

1. Take care to install correctly. No kinks, sags, pinches or loops.
2. The tubes and pipes must not be under tension when installed.
3. PE tubes must be trimmed to avoid loops and kinks. Take care when positioning before cutting and make a clean cut straight across the hose, using a sharp blade.

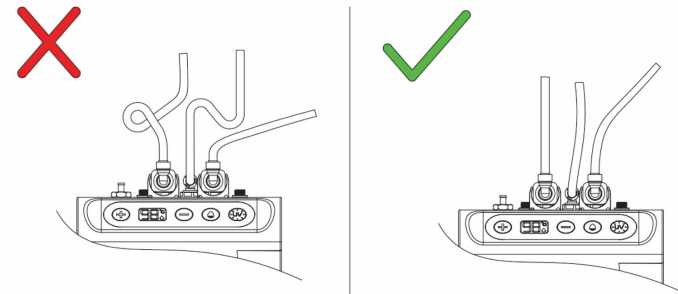

4. Follow the diagram and steps for proper PE tube handling.

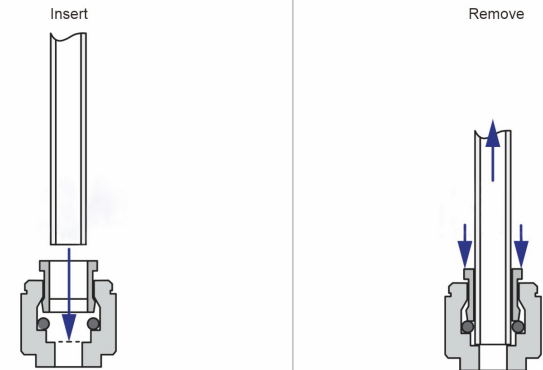

1. Cut tube clean and square.
2. Push tube firmly to end stop.

1. Press collet down.
2. Pull tube out.

Communication Cable Connection Precautions

1. When connecting the communication cable, make sure the connectors are properly aligned.

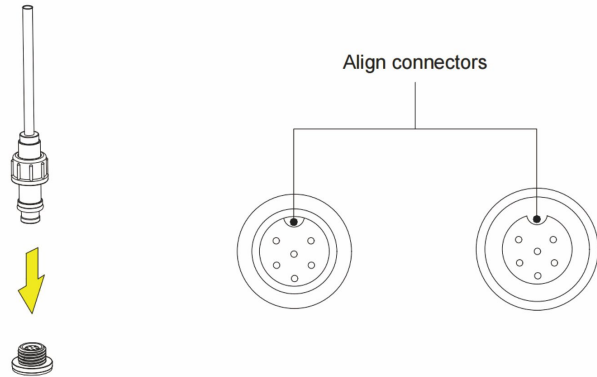
**Power-on Precautions**

1. Do not connect the power supply before installation is complete to prevent unit malfunction.

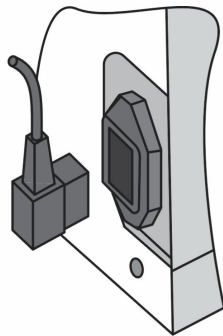
**UV Sterilization Module**

1. Pay attention to the arrow direction on the UV sterilization module during assembly.

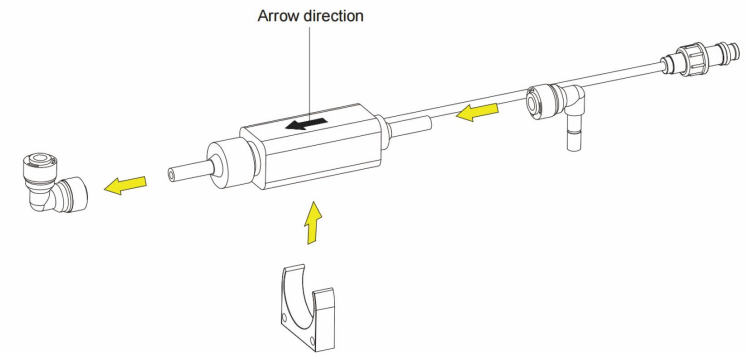

2. After assembling the UV sterilization module, secure it with the tube clip.

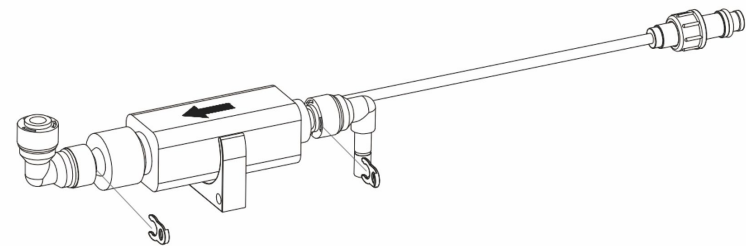

RO Filtration Unit Wastewater Drain Tube Precautions

1. The wastewater drain tube must be securely fixed to the drain pipe to prevent it from popping out due to internal pressure.

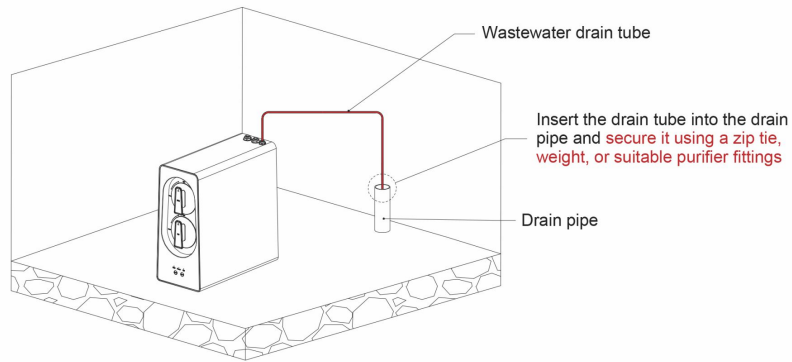

Safety Valve Drain Hose Precautions

1. The safety valve drain hose must be secured to the drain pipe.

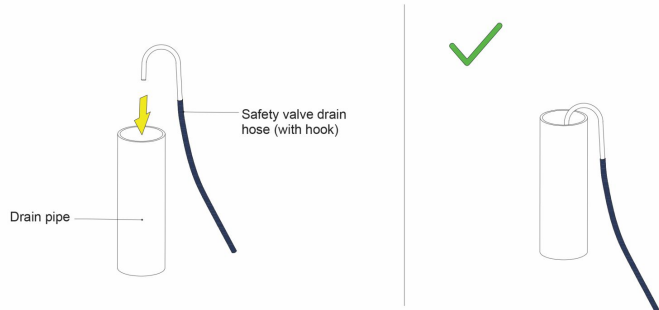

Connection Diagram

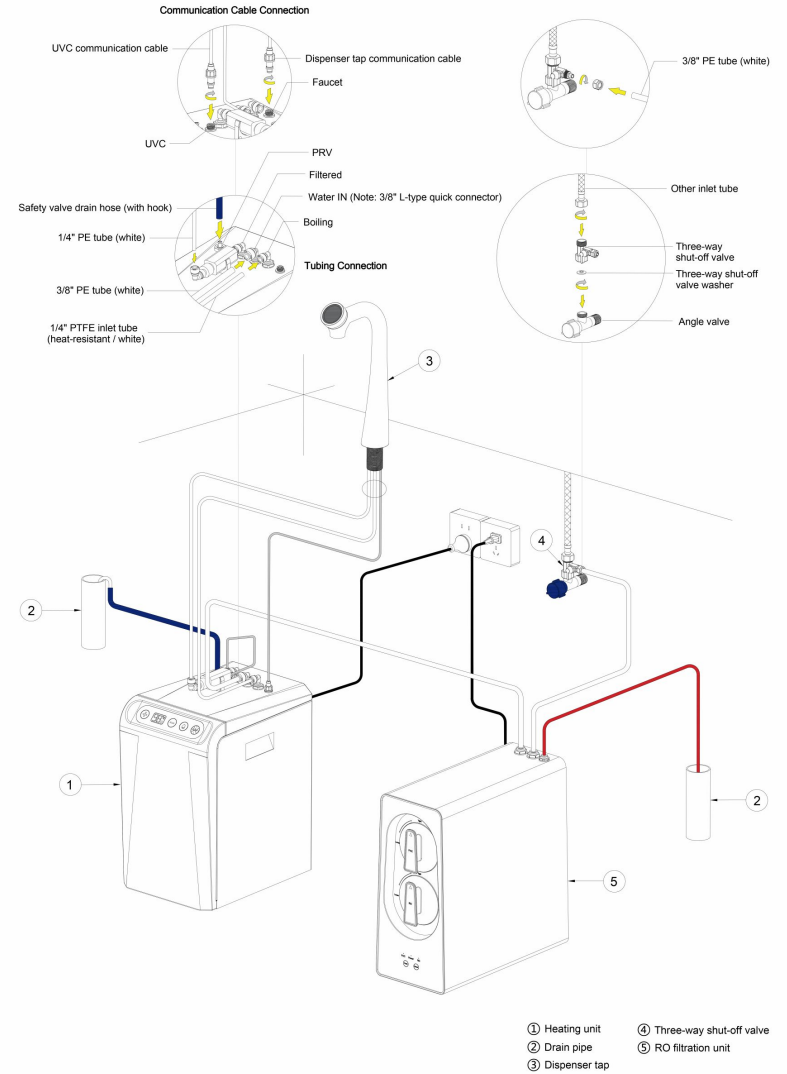

- ① Heating unit
- ② Drain pipe
- ③ Dispenser tap
- ④ Three-way shut-off valve
- ⑤ RO filtration unit

Post-installation Precautions

1. Check that all communication cables, water lines, and PE tubes are correctly connected. After confirming everything is secure, make sure all tube-to-fitting connections are locked in place with tube clips.

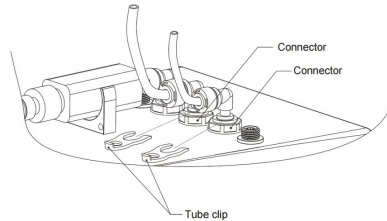

Pre-startup Precautions

1. Water Supply: Open the angle valve first, then open the three-way shut-off valve to supply water.

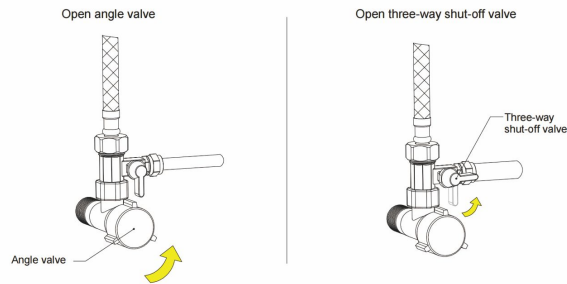

2. Power On Units: After confirming there are no leaks in the piping, turn on the power switches of the heating unit.

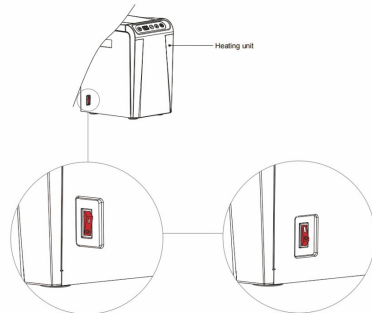

Warranty & Disclaimer

● Warranty

Coverage: Full Unit Warranty (applicable only to the original purchaser — B2B customers only; non-transferable)

Scope: Dispenser Tap, Heating Unit

Period: 18 months from the date of purchase

● Important Notice: This product must be connected to filtered water only (recommended TDS value below 50)

The following conditions are not covered under warranty:

- ① Yellowish water caused by sediment, sand, or impurities in the water source
- ② Malfunctions or irregularities caused by clogged impurities in the water source
- ③ No water output due to limescale buildup
- ④ Reduced heating performance due to limescale
- ⑤ Malfunctions or irregularities in the heating unit caused by limescale
- ⑥ Any other operational issues or malfunctions resulting from limescale buildup

● Disclaimer

1. Damage caused by human error or misuse:

- ① Physical damage from collisions, drops, or crushing during transportation or installation
- ② Malfunctions due to unauthorized modifications or the use of non-original parts
- ③ Improper installation or use not in accordance with the instruction manual
- ④ Damage caused by abnormal voltage (e.g., voltage instability) or improper power supply (e.g., no grounding)
- ⑤ Malfunctions due to unsuitable environmental conditions (e.g., excessively high/low temperatures, high humidity, direct sunlight exposure, poor ventilation)
- ⑥ Clogging or damage caused by poor water quality
- ⑦ Malfunctions caused by liquid or foreign objects entering non-designated internal areas of the product
- ⑧ Damage caused by insects, rodents, or pets
- ⑨ Corrosion, discoloration, or deformation caused by improper cleaning (e.g., using strong acids or alkalis)

2. Force Majeure Events:

- ① Natural disasters such as fire, flooding (including water damage from burst pipes), earthquakes, lightning strikes, typhoons, etc.
- ② Accidental events such as damage caused by transportation, war, riots, theft, or government actions
- ③ Interruptions or abnormalities in public utilities, including power, water, and gas supply, resulting in indirect loss or equipment malfunction

3. Damage to Appearance Components or Normal Wear and Tear:

- ① Natural aging of plastic parts or worn labels that do not affect the product's functionality are generally not covered under warranty
- ② Minor scratches, dents, or discoloration occurring during transportation or use that do not affect functionality are typically not covered
- ③ Reasonable performance changes over time—such as slight increases in operating noise—are considered normal wear and are not covered by the warranty as long as they remain within acceptable limits.

